



**MANAKIN** Elevation B  
2,474 sq ft

3 Beds 3 Baths 1 Story

DOWNLOAD FREE DIGITAL PLAN BOOK: [www.mitchellhomesinc.com](http://www.mitchellhomesinc.com)



Elevation A

# MANAKIN

2,474 sq ft

Finished Living Area: 2,474 sq ft  
Unfinished Bonus Area: 306 sq ft  
Garage: 550 sq ft  
Front Porch: 75 sq ft  
Stoop: 12 sq ft  
Total Area: 3,417 sq ft

## SALES & DESIGN CENTER LOCATIONS

Fredericksburg, VA  
888-905-0266

Newport News, VA  
888-608-0603

Richmond, VA  
888-352-0702

Rocky Mount, NC  
888-512-3779

info@mitchellhomesinc.com

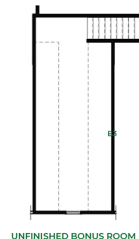

Plans and elevations are artist's renderings only, may not accurately represent the actual condition of a home as constructed, and may contain options which are not standard on all models. We reserve the right to make changes to these floor plans, specifications, dimensions, and elevations without prior notice. Stated dimensions and square footage are approximate and should not be used as representation of the home's precise or actual size.